

202.1 first floor

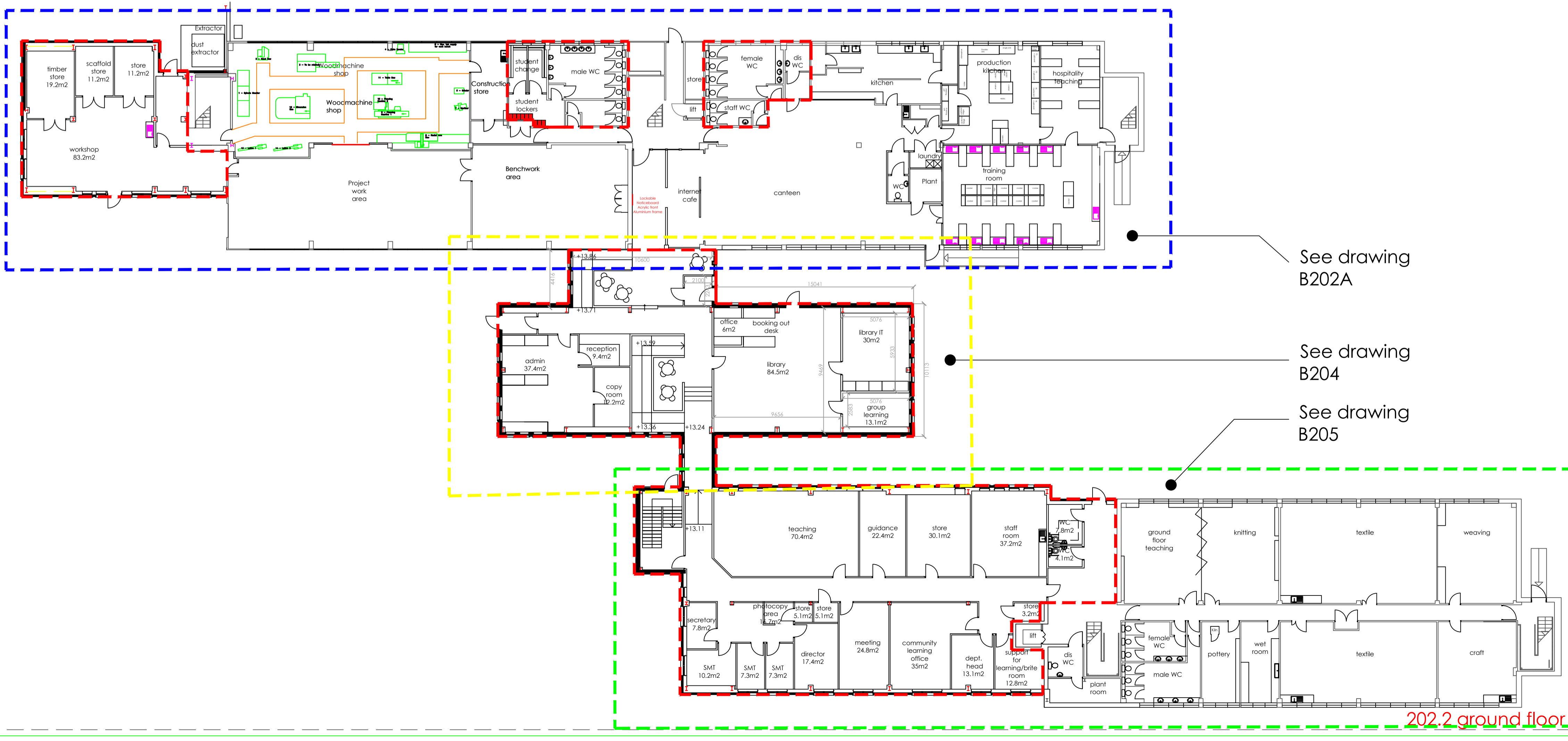

202.2 ground floor

Technical/VC/Studio Changes	F	14/02/2012
Construction Issue	F	January 2012
Reference to drawings	E	January 2012
cost cutting	D	October 2011
construction extension alterations	C	May 2011
construction/ hospitality / lower block redesign	B	April 2011
Revision upper building redesign a	No. A	Date March 2011

Shetland Islands Council
 Capital Programme Service
 Executive Services Department
 Greenhead Base, Lerwick, Shetland, ZE1 0PY
 Telephone: 744140 (STD Code 01595)
 Fax: 744136

Shetland College

Construction Issue

A1

Floor Plans	Job Code	Drw.No.	Rev.	Drawn
As proposed	UCL5203	UCL5203-B202	G	LAD
	Scale	Date	Date	AutoCAD File
	1:200@A1	Jan 2011	202	